

- 234 LS
- 3 AG
- 13 HT
- 180 LS
- 6 PO
- 25 AT

- 6 RG
- 90 LS
- 270 LS
- 3 AG
- 12 HY
- 25 JB

KEY BOTANICAL & COMMON NAME	QTY	SIZE	ROOT	REMARKS
Ornamental Trees				
AG Amelanchier x g. Autumn Brilliance/Serviceberry	6	6" tr.	B&B	Must be full, well rounded Specimen
ML Malus Sugar Tyne/White Flowering Crabapple	2	2" cal.	B&B	Quality Specimen
MS Malus sargentii/Sargent Crabapple (multistem)	3	4" tr.	B&B	Quality Specimen
Evergreen Shrubs				
JB Juniperus Broadmoor/Low Growing Juniper	25	5 gal.	Cont.	Quality Specimen
PM Pinus mugo var. Mugo/Dwarf Mugo Pine	7	36" wide	B&B	Quality Specimen
Deciduous Shrubs				
HY Hydrangea Blushing Bride/Hydrangea	25	3 gal.	Cont.	Quality Specimen
PO Physocarpus o. Diablo/Ninebark	6	30" ht.	Cont.	Quality Specimen
RG Rhus a. Gro Low/Gro Low Sumac	29	3 gal.	Cont.	Quality Specimen
Fern & Ornamental Grasses				
AT Athyrium filix-femina/Lady Fern	25	1 gal.	Cont.	Full Specimen
MA Miscanthus s. Yadigo/Dwarf Maiden Grass	7	1 gal.	Cont.	Full Specimen
Groundcover				
LS Linop spicata/Creeping Lilyturf	774	3-1/4"	cell	Full Specimens/ 18 cells per flat

LANDSCAPE KEY:

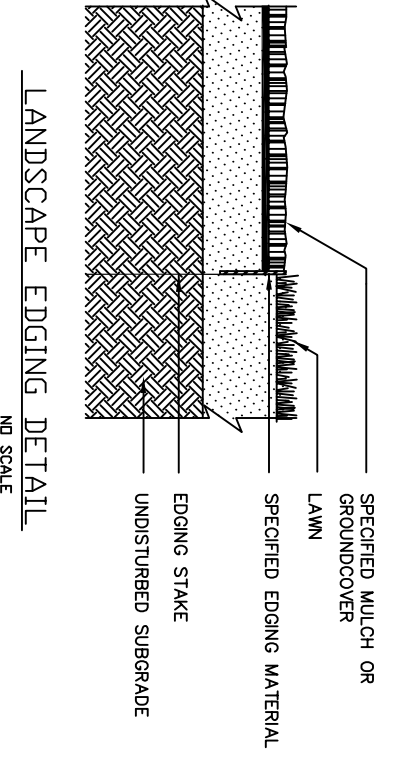
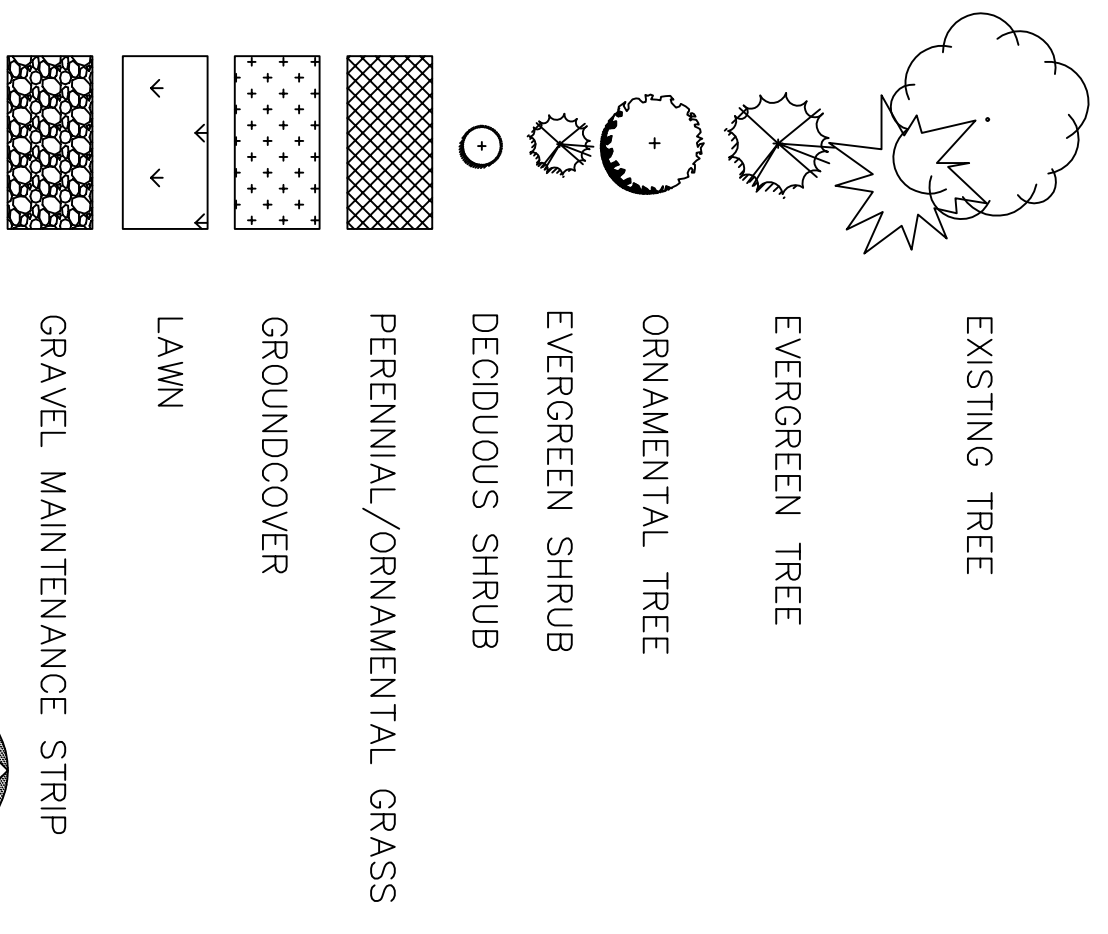

PERENNIAL PLANTING DETAIL

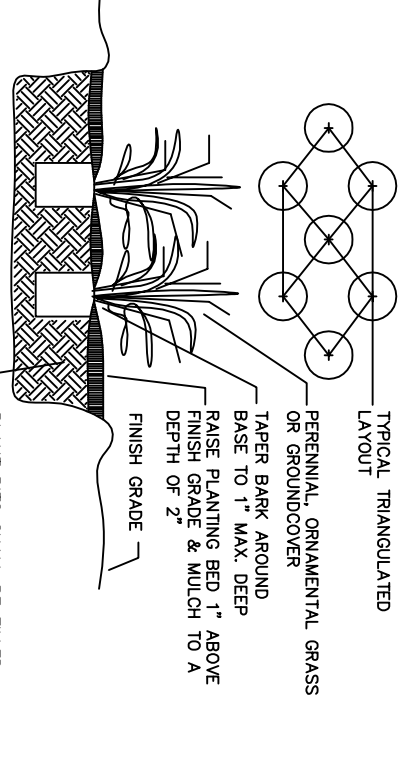

SHRUB PLANTING DETAIL

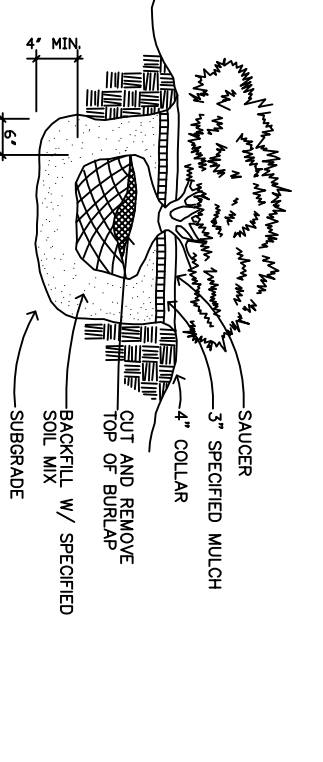

DECIDUOUS TREE PLANTING DETAIL

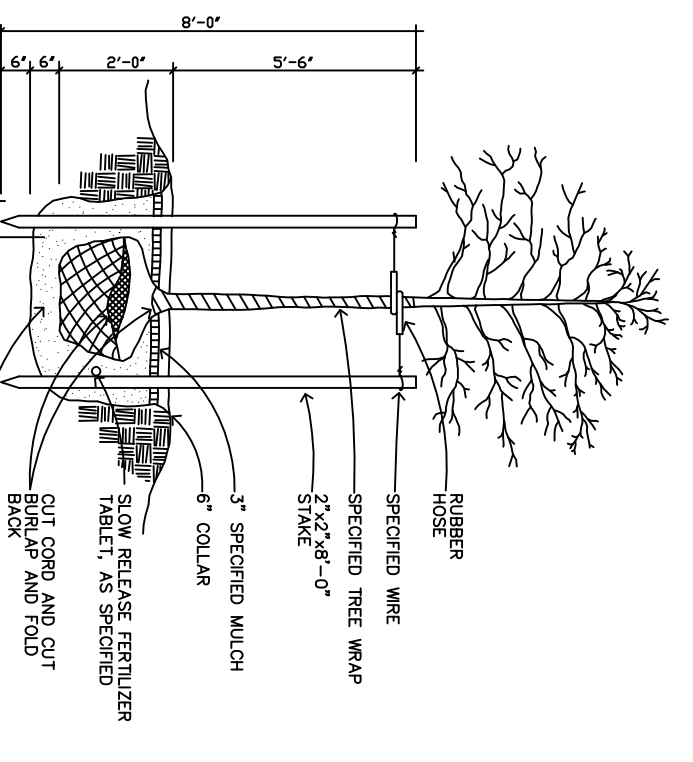

BATA SERVICE CENTER LANDSCAPE PLAN CASS ROAD, TRAVERSE CITY, MICHIGAN	FILE NO. 1131 DATE 11/04/11 SCALE 1" = 10'	REV# DATE DRN DESC 11/04/11 ACS BID SET	PH. 932.1925 FAX. 933.8773 330 W. 7th Street Traverse City, MI 49684 acsilverman@charter.net www.anitasilverman.com
---	--	--	--

